

# Linear

## Communications Solutions



### **Systems** Kits

**DMC-10** Components

**DMC-10** Faceplates

**DMC-1** System Kits

**DMC-1** Masters

**DMC-1** Room & Patio Stations

**DMC-1** Door Stations

**Standard** Mounting Frames

**Wire** & Cable

**DMC-1** System Diagram

**6-Wire** Retrofit System Diagram

**3-Wire** Retrofit Masters

**3-Wire** Retrofit Room & Patio Stations

**3-Wire** Retrofit Door Stations

**3-Wire** Retrofit Mounting Frames

**3-Wire** Retrofit System Diagram

**4-Wire** Retrofit Masters

**4-Wire** Retrofit Room & Patio Stations

**4-Wire** Retrofit Door Stations

**4-Wire** Retrofit Mounting Frames

**4-Wire** Retrofit System Diagram

**Retrofit** Reference

**Rough-In** Kits

**Rough-In** Components

**Wall Plates**

**Intercom** Speakers

**Intercom** Accessories

**Music** Distribution Systems



## An Innovative History



Linear was established in 1961 as a manufacturer of radio controls. Over the next four decades, an unrelenting dedication to quality has turned it into the most trusted name in everyday technology.

Long known for pioneering radio frequency in everyday use, Linear now combines passive infrared detection, digital electronics, and human engineering for a full range of products. Today, Linear opens your gates, your garages, and your front doors. You walk through Linear. You talk through Linear. You trust Linear every day.

Linear's prevalence across America is simply unprecedented. Hundreds of thousands of people use Linear products every day without even knowing it. Backed by the industry's best warranties, a network of qualified integrators and installers, and unrivaled electronic solutions know-how, it's no wonder that Linear continues to lead the industry forward.

Linear combines the latest in technology with simplicity and elegance. From gate operators to intercom systems to high-definition video distribution, these are innovations that are designed to make your life easier. These are innovations that make your life better.

# Linear Communications Solutions

## Order Info

### Sales Department:

5:00 AM — 4:30 PM (Pacific Time) Monday through Friday.

**By Phone:** 1 800 421 1587  
**By Fax:** 1 800 468 1340  
**By Web:** [linearcorp.com](http://linearcorp.com)  
**By Email:** [sales@linearcorp.com](mailto:sales@linearcorp.com)

### Technical Support for Dealers & Installers:

5:00 AM — 4:30 PM (Pacific Time) Monday through Friday.

**By Phone:** 1 800 421 1587  
**By Fax:** 1 760 438 7199  
**By Web:** [linearcorp.com](http://linearcorp.com)  
**By Email:** [techsupport@linearcorp.com](mailto:techsupport@linearcorp.com)

These Linear products are available nationwide at hundreds of conveniently located local distributor branches. These innovative products are available where you need them and when you need them, making Linear the natural choice for your communications solutions.

Linear Communications Solution products are distributed by:

All these brands are now under the Linear name.



# Contents

<b>Systems Kits</b>	03 – 03
<b>DMC-10</b> Components	04 – 04
<b>DMC-10</b> Faceplates	05 – 05
<b>DMC-1</b> System Kits	06 – 06
<b>DMC-1</b> Masters	07 – 07
<b>DMC-1</b> Room & Patio Stations	08 – 08
<b>DMC-1</b> Door Stations	09 – 09
<b>Standard</b> Mounting Frames	10 – 10
<b>Wire</b> & Cable	11 – 11
<b>DMC-1</b> System Diagram	12 – 12
<b>6-Wire</b> Retrofit System Diagram	13 – 13
<b>3-Wire</b> Retrofit Masters	14 – 14
<b>3-Wire</b> Retrofit Room & Patio Stations	15 – 15
<b>3-Wire</b> Retrofit Door Stations	16 – 16
<b>3-Wire</b> Retrofit Mounting Frames	17 – 18
<b>3-Wire</b> Retrofit System Diagram	19 – 19
<b>4-Wire</b> Retrofit Masters	20 – 20
<b>4-Wire</b> Retrofit Room & Patio Stations	21 – 22
<b>4-Wire</b> Retrofit Door Stations	23 – 23
<b>4-Wire</b> Retrofit Mounting Frames	24 – 25
<b>4-Wire</b> Retrofit System Diagram	26 – 26
<b>Retrofit</b> Reference	27 – 27
<b>Rough-In</b> Kits	28 – 29
<b>Rough-In</b> Components	30 – 31
<b>Wall Plates</b>	32 – 32
<b>Intercom</b> Speakers	32 – 33
<b>Intercom</b> Accessories	34 – 35
<b>Music</b> Distribution Systems	36 – 38
<b>Linear</b> Training	39 – 39
<b>Technical</b> Support	40 – 40
<b>Facilities</b>	41 – 41
<b>Index</b>	42 – 42

## 02 Introduction



Then...



Now...

Say “intercom,” and most people think of “tinny” sound and inconsistent performance...

### Those days are long gone!

Today, Linear’s communication and whole-house music distribution systems deliver true sound for music and voice. This catalog showcases elegant and sophisticated acoustical systems that deliver quality sound throughout the home. They also ensure peace of mind with enhanced security and room monitoring features.

For more than 50 years, a company named M&S Systems has been the leading designer and manufacturer of fine systems for home communication and entertainment. These products revolutionized home communications with technology, style, and value. That company is now part of Linear, where the legacy of quality in design and development continues on.

### Systems for new installations using Cat-5 wire

Linear’s DMC1 Music/Communications System offers much more than just good looks. Designed for today’s home, the DMC1 offers the homeowner the ability to communicate and monitor up to 15 rooms and supply AM/FM digitally tuned radio to each of those rooms. The 6-disc CD changer accessory can fill the home or patio with more than seven hours of music—all without reloading.

Linear’s DMC-10 Structured Wire Intercom System takes advantage of today’s modern homebuilding standard, a central wiring cabinet that provides a “structure” for all low-voltage signal distribution in the home. This hub-based intercom system features room, door, and patio stations in contemporary designs, crafted to blend into the installation’s decor.

### Systems for 3-wire, 4-wire, and 6-wire retrofit installations

Linear’s DMC3-4 offers many of the same features as the DMC1, but it is engineered to run on existing wires. The DMC3-4 will replace most older 3-wire or 4-wire M&S Systems and NuTone intercoms (use DMC1 for 6-wire retrofits). Unique retrofit finish-out frames make installation easy by eliminating the need to repair drywall. The DMC3-4 retrofit also offers an optional 6-disc CD changer.

**DMC-10KIT**

## Structured Wire Intercom Kit

- ORDER # DMC-10KIT



The Model DMC-10KIT Structured Wire Intercom Kit is an intercom system designed for structured wire installation in residential or light commercial applications. The kit includes the following:

- (1) - DMC-10H Structured Wire Intercom Hub
- (4) - DMC-10RS Intercom Room Stations
- (1) - DMC-10DS Intercom Door Station
- (1) - 12-volt Switching Power Supply

The room, door, and patio stations showcase a new, contemporary design, crafted to blend smoothly into the installation's decor. Station faceplates are available in a variety of colors to further customize each installation. Room station keypads are illuminated with soft blue indicators while the intercom is in use. The door and patio station keys are illuminated with white lighting for easy nighttime operation.

The heart of the system is the Model DMC-10H Structured Wire Intercom Hub. The system hub grid mounts in a structured wiring enclosure (not included, Linear H312KIT recommended). Up to eight room, door, and patio stations in any combination can be connected to the system hub using up to 500 feet of standard Cat-5 cable for each station. For larger installations, a second system hub can be added for expansion, providing a total system capacity of up to 16 stations. The Model DMC-10AWP Audio Input Wall Plate can be added to the system to connect an external audio source for distribution throughout the intercom system.

Each room and patio station supports several useful features. Privacy mute disables the station's microphone to prevent monitoring from other stations. The do-not-disturb feature disables the station's microphone and speaker to prevent monitoring and interruption. Hands-free reply lets the person called respond without having to press any room station keys.

The room, patio, and door stations mount inside standard 2-gang junction boxes and are easy to install and wire. Each station and the system hub contain color-coded Type 110 punch-down terminal blocks for fast and reliable connection to Cat-5 cable. A 12-volt switching power supply is included with each intercom hub. For access control, the optional Model DRW Door Release Mechanism can be installed and activated from room stations. A choice of three door chime sounds is available for each door station connected. For interior stations, use the Model DMC-10RS Room Stations. For exterior stations, use the Model DMC-10PS Patio Stations and the Model DMC-10DS Door Stations.

**Features:**

- White faceplates on stations
- Supports any mix of up to eight room, patio, or door stations, up to 16 stations using two hubs
- Hub connects to stations with standard Cat-5 wiring (up to 500 feet per station)
- Type 110 punch-down Cat-5 color-coded terminals for stations and optional expansion hub
- Privacy mute and door release overrides selectable by station
- 3-Amp-rated integral door release relay
- Operational status indicators on hub for each station
- Hub grid mounts in structured wiring enclosure (not included, Linear H312KIT recommended)
- Contemporary design room stations with multi-level blue keypad backlighting
- White faceplate included on room stations; almond and black available to match any decor
- White faceplate included on door station; bright brass, antique brass, and satin nickel available to match any decor
- Room station door talk, door release, mute functions, do-not-disturb, hands-free communications, and audible 8-step digital volume control
- Extended-life white LED backlit doorbell button on door station for easy night operation
- Choose from three distinct chime sounds for door station
- Door, room, and patio stations fit standard 2-gang J-box



# 04 DMC-10 Components

## DMC-10RS

### Intercom Room Station

- ORDER # DMC-10RS



#### Features:

- Contemporary design with multi-level blue keypad backlighting
- White faceplate included; almond and black available to match any decor
- Door talk and door release
- Privacy mute feature
- Do-not-disturb feature
- Hands-free reply
- Audible 8-step digital volume control
- Fits in standard 2-gang J-box

## DMC-10DS

### Intercom Door Station

- ORDER # DMC-10DS



#### Features:

- Contemporary design
- White faceplate included; antique brass, bright brass, and satin nickel available to match any decor
- Connects to intercom hub with standard Cat-5 wiring (up to 500 feet per station)
- Extended-life white LED backlit doorbell station for easy night operation
- Hands-free communications for the visitor

## DMC-10PS

### Intercom Patio Station

- ORDER # DMC-10PS



#### Features:

- Contemporary design with multi-level white keypad backlighting
- White faceplate included; antique brass, bright brass, and satin nickel available to match any decor
- Door talk
- Privacy mute feature
- Do-not-disturb feature
- Hands-free reply
- Audible 8-step digital volume control
- Fits in standard 2-gang J-box

## DMC-10H

### Structured Wire Intercom Hub

- ORDER # DMC-10H



The DMC-10H Structured Wire Intercom Hub grid mounts in a structured wiring enclosure (not included, Linear H312KIT recommended). Up to eight room, door, and patio stations in any combination can be connected to the system hub using up to 500 feet of standard Cat-5 cable for each station. For larger installations, a second system hub can be added for expansion, providing a total system capacity of up to 16 stations.

## DMC-10AWP

### Audio Input Wall Plate

- ORDER # DMC-10AWP



#### Features:

- External audio input connection for DMC-10H Structured Wire Intercom Hub
- Mounts in a single-gang J-box
- Fits Decora® faceplate
- One pair of color-coded RCA jacks
- One dry contact mute output mini-jack
- LED audio signal indicator
- Adjustable audio level control



## DMC-10 Faceplates

05

**DMC-10DFAB-4**

Door Station Faceplates (4-pack) (Antique Brass)

• ORDER # DMC-10DFAB-4

**DMC-10PFAB-4**

Patio Station Faceplates (4-pack) (Antique Brass)

• ORDER # DMC-10PFAB-4

**DMC-10RFA-4**

Room Station Faceplates (4-pack) (Almond)

• ORDER # DMC-10RFA-4

**DMC-10DFBB-4**

Door Station Faceplates (4-pack) (Bright Brass)

• ORDER # DMC-10DFBB-4

**DMC-10PFBB-4**

Patio Station Faceplates (4-pack) (Bright Brass)

• ORDER # DMC-10PFBB-4

**DMC-10RFB-4**

Room Station Faceplates (4-pack) (Black)

• ORDER # DMC-10RFB-4

**DMC-10DFSN-4**

Door Station Faceplates (4-pack) (Satin Nickel)

• ORDER # DMC-10DFSN-4

**DMC-10PFSN-4**

Patio Station Faceplates (4-pack) (Satin Nickel)

• ORDER # DMC-10PFSN-4

**DMC-10RFW-4**

Room Station Faceplates (4-pack) (White)

• ORDER # DMC-10RFW-4

**DMC-10DFW-4**

Door Station Faceplates (4-pack) (White)

• ORDER # DMC-10DFW-4

**DMC-10PFW-4**

Patio Station Faceplates (4-pack) (White)

• ORDER # DMC-10PFW-4



# 06 DMC-1 System Kits

## DMC1PACK

### Music/Communication System Package

• ORDER # DMC1PACK



The Model dmc1PACK and dmc1CDPACK Music/Communication System Packages offer many of the basic components needed to assemble a 4-room, 1-patio, and 1-entry-door music/communication system. The kit includes the following:

- (1) - Model dmc1 Music/Communication System Master (White)
- (1) - Model dmc1CD Add-on 6-disc CD Changer (White)\*
- (4) - Model dmc1RS Indoor Room Stations with Remote Scan and Master Volume (White)
- (1) - Model dmc1RW Patio Station with Remote Scan and Master Volume
- (1) - Model MC3 3-note Chime Module
- (1) - Model DS3B Intercom Door Speaker with Bell Button
- (1) - Model dmc1F Combination Mounting Frame (White)\*

For dmc1PACK rough-in components, order the Model dmc1HCKIT Wall Housing and Rough-in Ring Kit.

For dmc1CDPACK rough-in components, order the Model dmc1HKIT CD Combination Wall Housing and Rough-in Ring Kit.

## DMC1CDPACK

### Music/Communication System Package

• ORDER # DMC1CDPACK



#### Features:

- White faceplate
- Supports up to 15 room stations
- Supports up to three door speakers
- Cat-5 wiring to room and patio stations
- For new installations or 6-wire intercom system retrofit installations
- 30 watts (RMS) maximum output power
- Two music source inputs
- Eight AM and eight FM radio station tuner presets
- Remote volume and source control from room stations
- Privacy, intercom-only, and door-release features
- Programmable monitor override
- Automatic on/off feature
- Holds up to six compact discs\*
- 3-Note door chime included

\* dmc1CDPACK only

**DMC1**

Music/Communication System Master (White)

- ORDER # DMC1 (White)

**DMC1A**

Music/Communication System Master (Almond)

- ORDER # DMC1A (Almond)

**DMC1B**

Music/Communication System Master (Black)

- ORDER # DMC1B (Black)



The Model dmc1 Music/Communication System Master is a full-function intercom and music distribution system designed for residential use. The system supports up to 15 room stations and up to three door speakers. The built-in AM/FM radio tuner allows setting eight AM station presets and eight FM station presets. The backlit liquid crystal display shows the operation mode, audio source, radio frequency, volume setting, and time. With the optional Model dmc1CD Add-on 6-disc CD Changer installed, the display shows the disc number selected and the track number currently playing.

For master unit rough-in and finish-out components, order the Model dmc1H Wall Housing Kit to mount the dmc1 master. If the optional Model dmc1CD Add-on CD Changer is used, order the Model dmc1F Combination Mounting Frame and the dmc1HC CD Combination Wall Housing Kit.

**Features:**

- White, almond, or black faceplate
- Supports up to 15 room stations
- Supports up to three door speakers
- Cat-5 wiring to room and patio stations
- For new installations or 6-wire intercom system retrofit installations
- 30 watts (RMS) maximum output power
- Two music source inputs
- Eight AM and eight FM radio station tuner presets
- Remote volume and source control from room stations
- Privacy, intercom-only, and door-release features
- Programmable monitor override
- Automatic on/off feature
- Optional 3-note and 8-note door chime

**DMC1CD**

Add-On 6-Disc CD Changer (White)

- ORDER # DMC1CD (White)

**DMC1CDA**

Add-On 6-Disc CD Changer (Almond)

- ORDER # DMC1CDA (Almond)

**DMC1CDB**

Add-On 6-Disc CD Changer (Black)

- ORDER # DMC1CDB (Black)



The Model dmc1CD Add-on 6-disc CD Changer is a multi-disc compact disc player that connects to the dmc1 music/communications systems for a CD audio source input. The CD changer mounts below the master unit and contains a slide-in CD magazine that can hold up to six compact discs.

For rough-in and finish-out components, order the Model dmc1F Combination Mounting Frame and the dmc1HC CD Combination Wall Housing Kit.

**Features:**

- White, almond, or black faceplate
- Holds up to six compact discs
- Five operating modes
- Disc number displayed
- Track number displayed
- Number of tracks per CD displayed
- Track time displayed



# 08 DMC-1 Room & Patio Stations

## DMC1RS

Indoor Room Station with  
Remote Scan and Master Volume (White)

- ORDER # DMC1RS (White)

## DMC1RSA

Indoor Room Station with  
Remote Scan and Master Volume (Almond)

- ORDER # DMC1RSA (Almond)

## DMC1RSB

Indoor Room Station with  
Remote Scan and Master Volume (Black)

- ORDER # DMC1RSB (Black)

### Features:

- White, almond, or black faceplate
- Volume control sets sound level
- Privacy button to prevent monitoring from other room stations or master unit
- Communicates with door speakers, other room stations, and master unit
- Power, volume, and scan control of the master unit's built-in AM/FM radio receiver
- Scans auxiliary, CD, AM, and FM sources
- Can activate door release mechanism or a security system's panic alarm



## DMC1R

Indoor Room Station

- ORDER # DMC1R

## DMC1RW

Patio Station with Remote Scan and Master Volume

- ORDER # DMC1RW



### Features:

- White faceplate
- Volume control sets sound level
- Privacy button to prevent monitoring from other room stations or master unit
- Communicates with door speakers, other room stations, and master unit

### Features:

- White faceplate
- Volume control sets sound level
- Privacy button to prevent monitoring from other room stations or master unit
- Communicates with door speakers, other room stations, and master unit
- Power, volume, and scan control of the master unit's built-in AM/FM radio receiver
- Scans auxiliary, CD, AM, and FM sources

# DMC-1 Door Stations 09

## DS3B

Intercom Door Station with Bell Button (White)

- ORDER # DS3B (White)

## DS3NB

Intercom Door Station with Bell Button (Nickel)

- ORDER # DS3NB (Nickel)

## BD3BN

Intercom Door Station with Bell Button (Bright Brass)

- ORDER # BD3BN (Bright Brass)

## D3BN

Intercom Door Station with Bell Button (Antique Brass)

- ORDER # D3BN (Antique Brass)

### Features:

- White, nickel, bright brass, or antique brass-finished faceplate
- Lighted doorbell button
- 2-Way voice communications
- Mounts in Model ME3 Door Station Rough-in Enclosure



## DS3

Intercom Door Station (White)

- ORDER # DS3 (White)

## BD3N

Intercom Door Station (Bright Brass)

- ORDER # BD3N (Bright Brass)

## D3N

Intercom Door Station (Antique Brass)

- ORDER # D3N (Antique Brass)

### Features:

- White, bright brass, or antique brass-finished faceplate
- 2-Way voice communications
- Mounts in Model ME3 Door Station Rough-in Enclosure



# 10 Standard Mounting Frames

## DMC1F

Combination Mounting Frame (White)

- ORDER # DMC1F (White)

## DMC1FA

Combination Mounting Frame (Almond)

- ORDER # DMC1FA (Almond)

## DMC1FB

Combination Mounting Frame (Black)

- ORDER # DMC1FB (Black)

The Model dmc1F Combination Mounting Frame is used in new and retrofit intercom installations. The frame is designed to fit a dmc1 or dmc3-4 Music/Communication System Master and dmc1CD Add-on 6-disc CD Changer.

In new installations, use the dmc1F combination frame when installing a dmc1 with a dmc1CD below the master.

In retrofit installations, use the dmc1F combination frame when replacing a master-only system with a dmc3-4 or dmc1 and a dmc1CD below the master. NOTE: The wall hole will need to be enlarged for this type of retrofit installation.

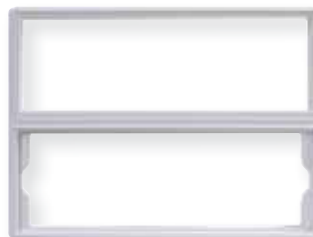

## DMC1FG

Master Gap Frame

- ORDER # DMC1FG



The Model dmc1FG Master Gap Frame is used in installations where a gap is exposed around the master mounting hole. The frame is designed to fit dmc1 and dmc3-4 masters.

## DMC1FRG

Room Station Gap Frame

- ORDER # DMC1FRG



The Model dmc1FRG Room Station Gap Frame is used in installations where a gap is exposed around the room station mounting hole. The frame is designed to fit all dmc1 indoor room stations.



## MS2SX5SC

### Shielded Speaker Cable

- ORDER # MS2SX5SC

The Model MS2SX5SC Shielded Speaker Cable is 2-conductor, 22-gauge, shielded cable. The cable is supplied in a 500-foot roll. The cable's shielding reduces outside electrical interference from radio frequency sources.

The cable's jacket is yellow. The cable contains two solid copper 22-gauge wires with blue and violet insulation. The blue and violet wires are foil shielded as a pair and have a shield drain wire.

This cable is typically used for connecting a Model FMSM, FMC8, NR8M, or NR8P 45-ohm Intercom Speaker to a Model MVC1 Monaural Volume Control.



## MS4DCX5SC

### Shielded Door Station Cable

- ORDER # MS4DCX5SC

The Model MS4DCX5SC Shielded Door Station Cable is 4-conductor, 22-gauge, shielded cable. The cable is supplied in a 500-foot roll. The cable's shielding reduces outside electrical interference from radio frequency sources.

The cable's jacket is orange. The cable contains four solid copper 22-gauge wires with red, black, orange, and yellow insulation. The red and black wires are foil shielded as a pair and have a shield drain wire. The orange and yellow wires are foil shielded as a pair and have a shield drain wire.

This cable is typically used to connect door stations to dmc1 and dmc3-4 systems.



## PBVM127X1

### Low-Voltage 2-Conductor Wire Pull Box

- ORDER # PBVM127X1

The Model PBVM127X1 Low-voltage 2-conductor Wire Pull Box is 2-conductor 18-gauge wire. The wire is supplied in a 1,000-foot pull box for easy wire installation.

The cable contains two solid copper 18-gauge wires with red and white insulation.

This cable is typically used for connecting RT11 Remote Transformers and DRW Door Release Mechanisms to dmc1 and dmc3-4 systems.





# 12 DMC-1 System Diagram

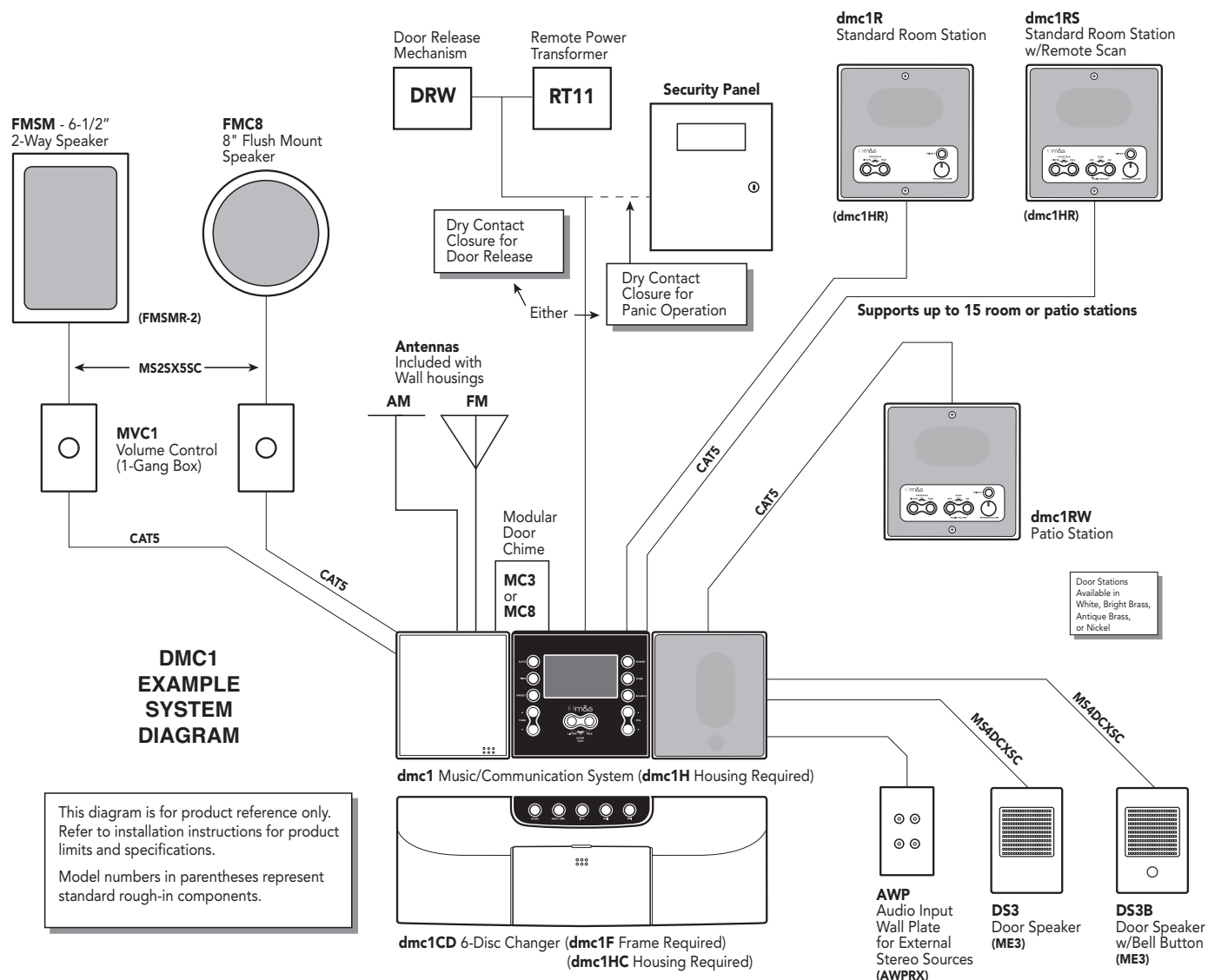

# 6-Wire Retrofit System Diagram 13

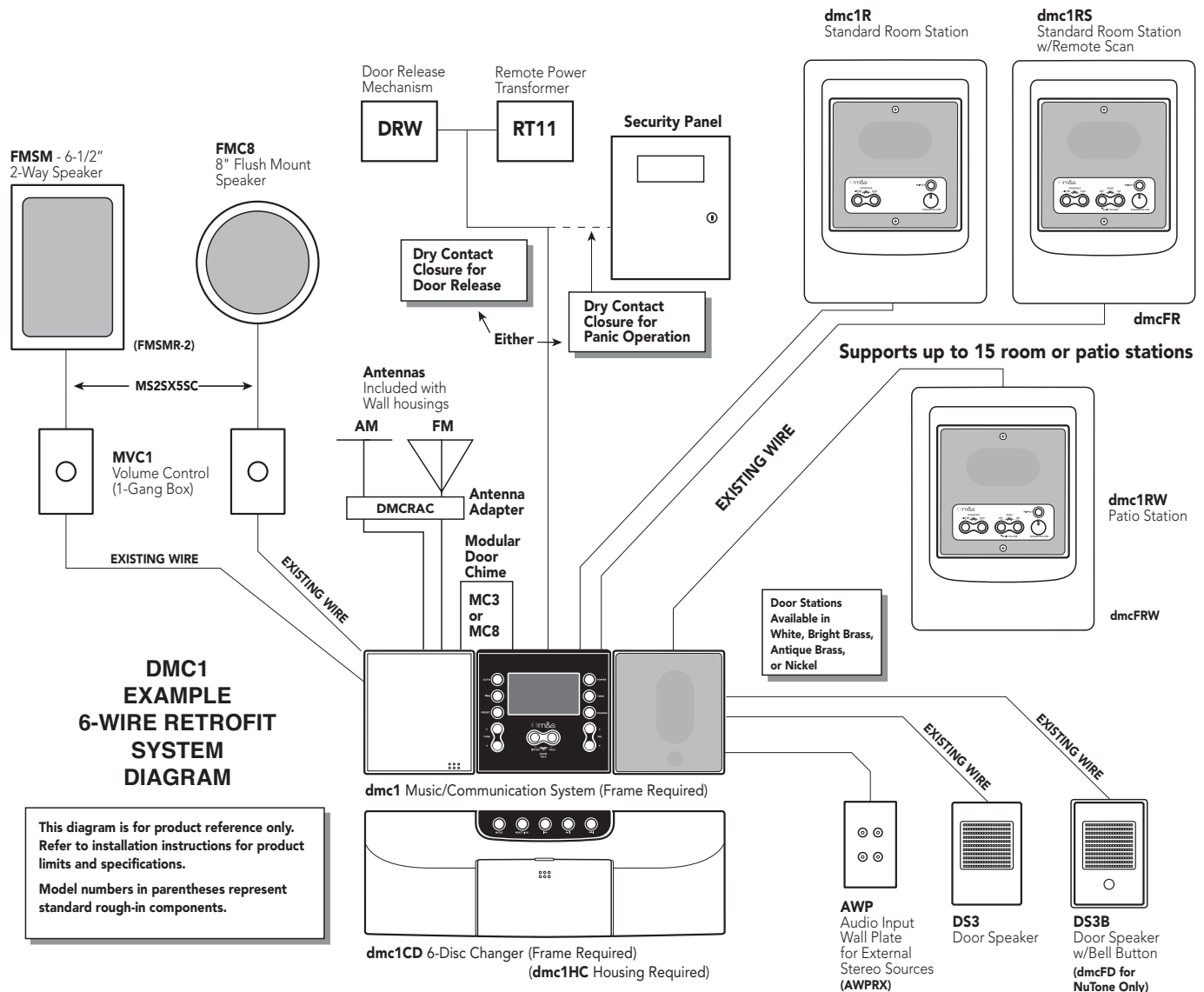

# 14 3-Wire Retrofit Masters

## DMC3-4 Music/Communication Retrofit System Master (White)

- ORDER # DMC3-4 (White)

## DMC3-4A Music/Communication Retrofit System Master (Almond)

- ORDER # DMC3-4A (Almond)

## DMC3-4B Music/Communication Retrofit System Master (Black)

- ORDER # DMC3-4B (Black)



The Model dmc3-4 Music/Communication Retrofit System Master is a full-function intercom and music distribution system designed for retrofit applications in residential use. The master unit can replace older intercom systems that use 3-wire connections to the room stations. The system supports up to 15 room stations and up to three door speakers. The built-in AM/FM radio tuner allows setting eight AM station presets and eight FM station presets. The backlit liquid crystal display shows the operation mode, audio source, radio frequency, volume setting, and time. With the optional Model dmc1CD Add-on 6-disc CD Changer installed, the display shows the disc number selected and the track number currently playing.

Room stations have pushbuttons that control the system operation. Retrofit room and patio stations connect to the master unit using the installation's existing wiring. All room station models can talk to other room stations, door speakers, and the master unit. Each has an intercom volume control. The Model dmc3RS Room Station and dmc3RW Patio Station can select the audio source, control the radio tuner, and set the master music volume.

### Features:

- White, almond, or black faceplate
- Retrofit for 3-wire intercom systems
- Supports up to 15 room stations
- Supports up to three door speakers
- 30 watts (RMS) maximum output power
- Two music source inputs
- Eight AM and eight FM radio station tuner presets
- Remote volume and source control from room stations
- Intercom-only and door-release features
- Programmable monitor override
- Automatic on/off feature
- Optional 3-note and 8-note door chime

## DMC1CD

### Add-On 6-Disc CD Changer (White)

- ORDER # DMC1CD (White)

## DMC1CDA

### Add-On 6-Disc CD Changer (Almond)

- ORDER # DMC1CDA (Almond)

## DMC1CDB

### Add-On 6-Disc CD Changer (Black)

- ORDER # DMC1CDB (Black)

The Model dmc1CD Add-on 6-disc CD Changer is a multi-disc compact disc player that connects to the dmc3-4 Music/Communications System for a CD audio source input. The CD changer mounts below the master unit and contains a slide-in CD magazine that can hold up to six compact discs.

### Features:

- White, almond, or black faceplate
- Holds up to six compact discs
- Five operating modes
- Disc number displayed
- Track number displayed
- Number of tracks per CD displayed
- Track time displayed



# 3-Wire Retrofit Room & Patio Stations 15

## DMC3RS

Retrofit Indoor Room Station with Remote Scan and Master Volume (White)

- ORDER # DMC3RS (White)

## DMC3RSA

Retrofit Indoor Room Station with Remote Scan and Master Volume (Almond)

- ORDER # DMC3RSA (Almond)

## DMC3RSB

Retrofit Indoor Room Station with Remote Scan and Master Volume (Black)

- ORDER # DMC3RSB (Black)

### Features:

- White, almond, or black faceplate
- Retrofit for 3-wire intercom systems
- Volume control sets sound level
- Communicates with door speakers, other room stations, and master unit
- Power, volume, and scan control of the master unit's built-in AM/FM radio receiver
- Scans auxiliary, CD, AM, and FM sources
- Can activate door release mechanism or a security system's panic alarm



## DMC3R

Retrofit Indoor Room Station

- ORDER # DMC3R

## DMC3RW

Retrofit Patio Station with Remote

- ORDER # DMC3RW



### Features:

- White faceplate
- Retrofit for 3-wire intercom systems
- Volume control sets sound level
- Communicates with door speakers, other room stations and master unit

### Features:

- White faceplate
- Retrofit for 3-wire intercom systems
- Volume control sets sound level
- Communicates with door speakers, other room stations, and master unit
- Power, volume, and scan control of the master unit's built-in AM/FM radio receiver
- Scans auxiliary, CD, AM, and FM sources

# 16 3-Wire Retrofit Door Stations

## DS3B

Intercom Door Station with Bell Button (White)

- ORDER # DS3B (White)

## DS3NB

Intercom Door Station with Bell Button (Nickel)

- ORDER # DS3NB (Nickel)

## BD3BN

Intercom Door Station with Bell Button (Bright Brass)

- ORDER # BD3BN (Bright Brass)

## D3BN

Intercom Door Station with Bell Button (Antique Brass)

- ORDER # D3BN (Antique Brass)

### Features:

- White, nickel, bright brass, or antique brass-finished faceplate
- Lighted doorbell button
- 2-Way voice communications
- Mounts in Model ME3 Door Station Rough-in Enclosure



## DS3

Intercom Door Station (White)

- ORDER # DS3 (White)

## BD3N

Intercom Door Station (Bright Brass)

- ORDER # BD3N (Bright Brass)

## D3N

Intercom Door Station (Antique Brass)

- ORDER # D3N (Antique Brass)

### Features:

- White, bright brass, or antique brass-finished faceplate
- 2-Way voice communications
- Mounts in Model ME3 Door Station Rough-in Enclosure



# Retrofit Mounting Frames 17

## DMCFM

Master Retrofit Mounting Frame (White)

- ORDER # DMCFM (White)

## DMCFMA

Master Retrofit Mounting Frame (Almond)

- ORDER # DMCFMA (Almond)

## DMCFMB

Master Retrofit Mounting Frame (Black)

- ORDER # DMCFMB (Black)

The Model dmcFM Master Retrofit Mounting Frame is used in retrofit intercom installations when replacing a master-only system with a dmc3-4 Music/Communication Retrofit System Master or a dmc1 Music/Communication System Master in a 6-wire retrofit installation.



## DMCFC

Combination Retrofit Mounting Frame (White)

- ORDER # DMCFC (White)

## DMCFCA

Combination Retrofit Mounting Frame (Almond)

- ORDER # DMCFCA (Almond)

## DMCFCB

Combination Retrofit Mounting Frame (Black)

- ORDER # DMCFCB (Black)

The Model dmcFC Combination Retrofit Mounting Frame is used in retrofit intercom installations when replacing a combination system with a dmc3-4 Music/Communication Retrofit System Master or a dmc1 Music/Communication System Master in a 6-wire retrofit installation with a dmc1CD below the master.



# 18 Retrofit Mounting Frames

## DMCFR

Room Station Retrofit Mounting Frame (White)

- ORDER # DMCFR (White)

The Model dmcFR Room Station Retrofit Mounting Frame is used in retrofit intercom installations when replacing older room stations with Model dmc3R, dmc3RS, dmc4R, and dmc4RS Room Stations.

## DMCFRA

Room Station Retrofit Mounting Frame (Almond)

- ORDER # DMCFRA (Almond)

## DMCFRB

Room Station Retrofit Mounting Frame (Black)

- ORDER # DMCFRB (Black)



## DMCFD

Door Station Retrofit Mounting Frame

- ORDER # DMCFD

## DMCFRW

Patio Station Retrofit Mounting Frame

- ORDER # DMCFRW



The Model dmcFD Door Station Retrofit Mounting Frame is used in retrofit intercom installations when replacing a NuTone door station. This frame is not required when replacing old-style M&S brand door stations in a retrofit installation. This retrofit mounting frame fits Model BD3N, BD3BN, D3N, D3BN, DS3, and DS3B Door Stations.

The Model dmcFRW Patio Station Retrofit Mounting Frame is used in retrofit intercom installations when replacing an older outdoor patio station with a Model dmc3RW or dmc4RW Retrofit Patio Station.



# 3-Wire Retrofit System Diagram 19

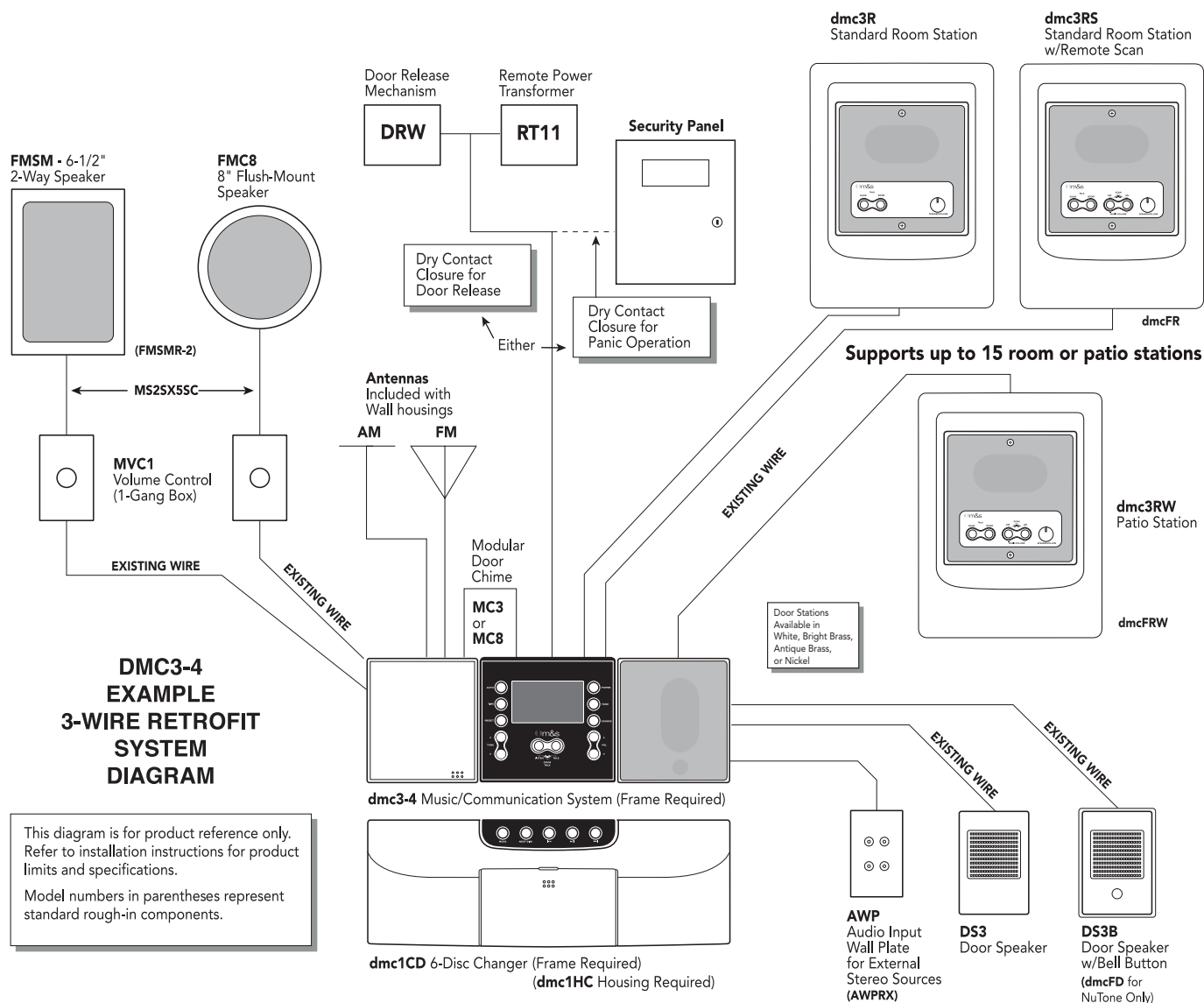

# 20 4-Wire Retrofit Masters

## DMC3-4 Music/Communication Retrofit System Master (White)

- ORDER # DMC3-4 (White)

## DMC3-4A Music/Communication Retrofit System Master (Almond)

- ORDER # DMC3-4A (Almond)

## DMC3-4B Music/Communication Retrofit System Master (Black)

- ORDER # DMC3-4B (Black)



The Model dmc3-4 Music/Communication Retrofit System Master is a full-function intercom and music distribution system designed for retrofit applications in residential use. The master unit can replace older intercom systems that use 4-wire connections to the room stations. The system supports up to 15 room stations and up to three door speakers. The built-in AM/FM radio tuner allows setting eight AM station presets and eight FM station presets. The backlit liquid crystal display shows the operation mode, audio source, radio frequency, volume setting, and time. With the optional Model dmc1CD Add-on 6-disc CD Changer installed, the display shows the disc number selected and the track number currently playing.

Room stations have pushbuttons that control the system operation. Retrofit room and patio stations connect to the master unit using the installation's existing wiring. All room station models allow you to talk or listen to other room stations, door speakers, and the master unit. Each has an intercom volume control. The Model dmc4rs Room Station and dmc4RW Patio Station can select the audio source, control the radio tuner, and set the master music volume.

### Features:

- White, almond, or black faceplate
- Retrofit for 4-wire intercom systems
- Supports up to 15 room stations
- Supports up to three door speakers
- 30 watts (RMS) maximum output power
- Two music source inputs
- Eight AM and eight FM radio station tuner presets
- Remote volume and source control from room stations
- Intercom-only and door-release features
- Programmable monitor override
- Automatic on/off feature
- Optional 3-note and 8-note door chime

## DMC1CD Add-On 6-Disc CD Changer (White)

- ORDER # DMC1CD (White)

## DMC1CDA Add-On 6-Disc CD Changer (Almond)

- ORDER # DMC1CDA (Almond)

## DMC1CDB Add-On 6-Disc CD Changer (Black)

- ORDER # DMC1CDB (Black)

The Model dmc1CD Add-on 6-disc CD Changer is a multi-disc compact disc player that connects to the dmc1 or dmc3-4 music/communications systems for a CD audio source input. The CD changer mounts below the master unit and contains a slide-in CD magazine that can hold up to six compact discs.

### Features:

- White, almond, or black faceplate
- Holds up to six compact discs
- Five operating modes
- Disc number displayed
- Track number displayed
- Number of tracks per CD displayed
- Track time displayed



# 4-Wire Retrofit Room & Patio Stations 21

## **DMC4RS** Retrofit Indoor Room Station with Remote Scan and Master Volume (White)

- ORDER # DMC4RS (White)

## **DMC4RSA** Retrofit Indoor Room Station with Remote Scan and Master Volume (Almond)

- ORDER # DMC4RSA (Almond)

## **DMC4RSB** Retrofit Indoor Room Station with Remote Scan and Master Volume (Black)

- ORDER # DMC4RSB (Black)

### Features:

- White, almond, or black faceplate
- Retrofit for 4-wire intercom systems
- Volume control sets sound level
- Communicates with door speakers, other room stations, and master unit
- Power, volume, and scan control of the master unit's built-in AM/FM radio receiver
- Scans auxiliary, CD, AM, and FM sources
- Can activate door release mechanism or a security system's panic alarm



## **DMC4R** Retrofit Indoor Room Station

- ORDER # DMC4R

## **DMC4RW** Retrofit Patio Station with Remote Scan and Master Volume

- ORDER # DMC4RW



### Features:

- White faceplate
- Retrofit for 4-wire intercom systems
- Volume control sets sound level
- Communicates with door speakers, other room stations, and master unit

### Features:

- White faceplate
- Retrofit for 4-wire intercom systems
- Volume control sets sound level
- Communicates with door speakers, other room stations, and master unit
- Power, volume, and scan control of the master unit's built-in AM/FM radio receiver
- Scans auxiliary, CD, AM, and FM sources

# 22 4-Wire Retrofit Room & Patio Stations

## N68RS Retrofit Large Indoor Room Station with Remote Scan and Master Volume

• ORDER # N68RS

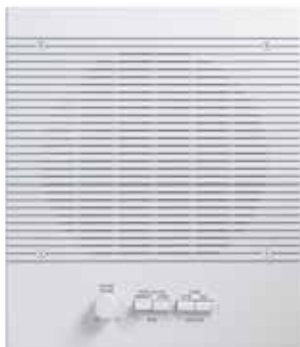

### Features:

- White faceplate
- Retrofit for 4-wire intercom systems only
- Volume control sets sound level
- Communicates with door speakers, other room stations, and master unit
- Power, volume, and scan control of the master unit's built-in AM/FM radio receiver
- Scans auxiliary, CD, AM, and FM sources

## NW65RS Retrofit Patio Station with Remote Scan and Master Volume

• ORDER # NW65RS



### Features:

- White faceplate
- Retrofit for 4-wire intercom systems only
- Volume control sets sound level
- Communicates with door speakers, other room stations, and master unit
- Power, volume, and scan control of the master unit's built-in AM/FM radio receiver
- Scans auxiliary, CD, AM, and FM sources

## NW68RS Retrofit Large Patio Station with Remote Scan and Master Volume

• ORDER # NW68RS



### Features:

- White faceplate
- Retrofit for 4-wire intercom systems only
- Volume control sets sound level
- Communicates with door speakers, other room stations, and master unit
- Power, volume, and scan control of the master unit's built-in AM/FM radio receiver
- Scans auxiliary, CD, AM, and FM sources

# 4-Wire Retrofit Door Stations 23

## DS3B

Intercom Door Station with Bell Button (White)

- ORDER # DS3B (White)

## DS3NB

Intercom Door Station with Bell Button (Nickel)

- ORDER # DS3NB (Nickel)

## BD3BN

Intercom Door Station with Bell Button (Bright Brass)

- ORDER # BD3BN (Bright Brass)

## D3BN

Intercom Door Station with Bell Button (Antique Brass)

- ORDER # D3BN (Antique Brass)

### Features:

- White, nickel, bright brass, or antique brass-finished faceplate
- Lighted doorbell button
- 2-Way voice communications
- Mounts in Model ME3 Door Station Rough-in Enclosure



## DS3

Intercom Door Station (White)

- ORDER # DS3 (White)

## BD3N

Intercom Door Station (Bright Brass)

- ORDER # BD3N (Bright Brass)

## D3N

Intercom Door Station (Antique Brass)

- ORDER # D3N (Antique Brass)

### Features:

- White, bright brass, or antique brass-finished faceplate
- 2-Way voice communications
- Mounts in Model ME3 Door Station Rough-in Enclosure



# 24 4-Wire Retrofit Mounting Frames

## DMCFM

Master Retrofit Mounting Frame (White)

- ORDER # DMCFM (White)

The Model dmcFM Master Retrofit Mounting Frame is used in retrofit intercom installations when replacing a master-only system with a dmc3-4 Music/Communication Retrofit System Master or a dmc1 Music/Communication System Master in a 6-wire retrofit installation.

## DMCFMA

Master Retrofit Mounting Frame (Almond)

- ORDER # DMCFMA (Almond)

## DMCFMB

Master Retrofit Mounting Frame (Black)

- ORDER # DMCFMB (Black)



## DMCFC

Combination Retrofit Mounting Frame (White)

- ORDER # DMCFC (White)

The Model dmcFC Combination Retrofit Mounting Frame is used in retrofit intercom installations when replacing a combination system with a dmc3-4 Music/Communication Retrofit System Master or a dmc1 Music/Communication System Master in a 6-wire retrofit installation with a dmc1CD below the master.

## DMCFCA

Combination Retrofit Mounting Frame (Almond)

- ORDER # DMCFCA (Almond)

## DMCFCB

Combination Retrofit Mounting Frame (Black)

- ORDER # DMCFCB (Black)



# 4-Wire Retrofit Mounting Frames 25

## DMCFR

Room Station Retrofit Mounting Frame (White)

- ORDER # DMCFR (White)

The Model dmcFR Room Station Retrofit Mounting Frame is used in retrofit intercom installations when replacing older room stations with Model dmc3R, dmc3RS, dmc4R, and dmc4RS Room Stations.

## DMCFRA

Room Station Retrofit Mounting Frame (Almond)

- ORDER # DMCFRA (Almond)

## DMCFRB

Room Station Retrofit Mounting Frame (Black)

- ORDER # DMCFRB (Black)



## DMCFD

Door Station Retrofit Mounting Frame

- ORDER # DMCFD

## DMCFRW

Patio Station Retrofit Mounting Frame

- ORDER # DMCFRW



The Model dmcFD Door Station Retrofit Mounting Frame is used in retrofit intercom installations when replacing a NuTone door station. This frame is not required when replacing old-style M&S brand door stations in a retrofit installation. This retrofit mounting frame fits Model BD3N, BD3BN, D3N, D3BN, DS3, and DS3B Door Stations.

The Model dmcFRW Patio Station Retrofit Mounting Frame is used in retrofit intercom installations when replacing an older outdoor patio station with a Model dmc3RW or dmc4RW Retrofit Patio Station.



# 26 4-Wire Retrofit System Diagram

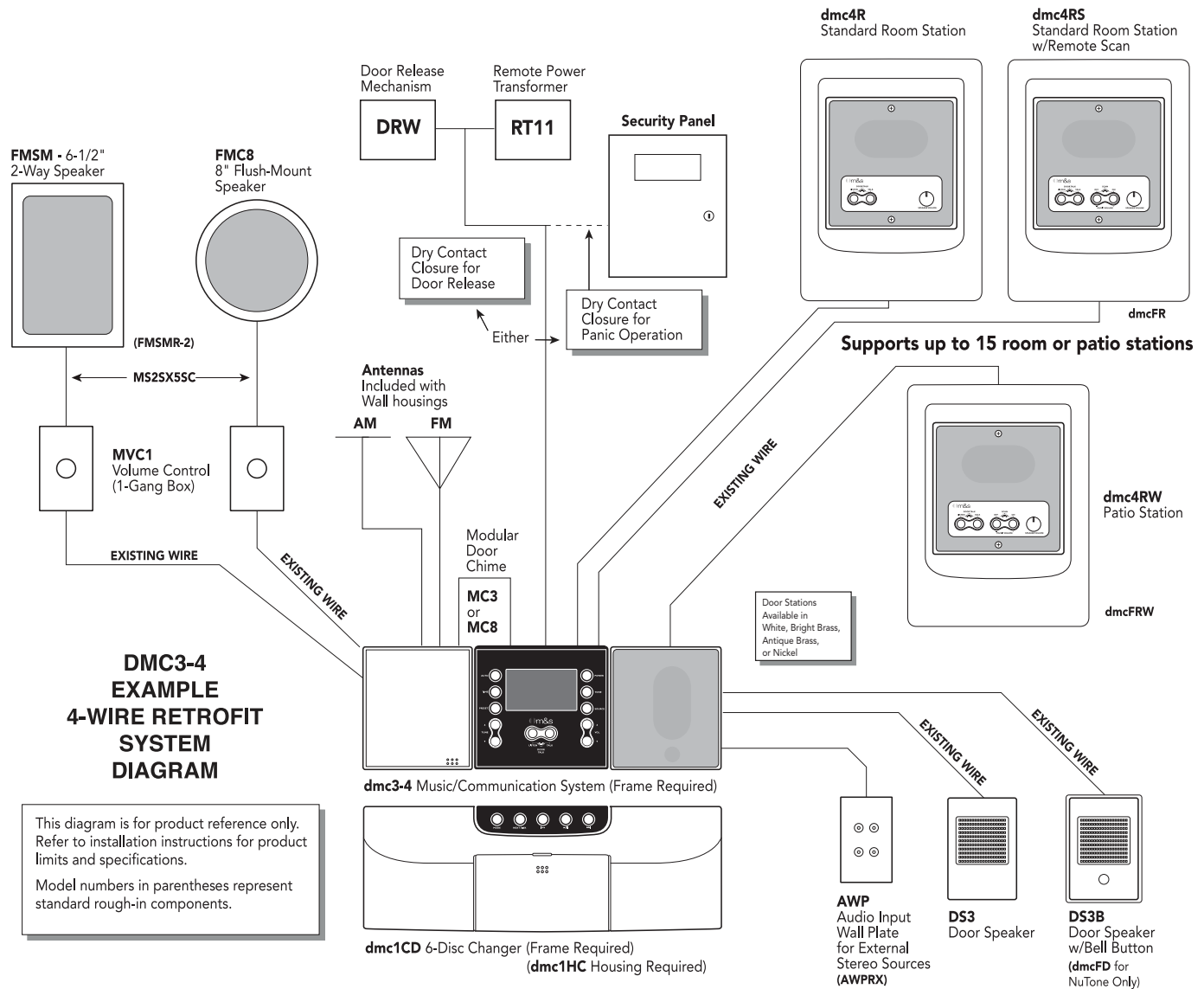

## RETROFIT INSTALLATION INTERCOM MODEL COMPATIBILITY TABLE

MANUFACTURER OF OLD INTERCOM	OLD MODEL TO RETROFIT	OLD MODEL WIRING SYSTEM	RETROFIT WITH 3-WIRE DMC3-4 SYSTEM	RETROFIT WITH 4-WIRE DMC3-4 SYSTEM	RETROFIT WITH 6-WIRE DMC1 SYSTEM
M&S Systems	5	3-Wire System	✓		
	6	4-Wire System		✓	
	10 Series	4-Wire System		✓	
	20 Series	4-Wire System		✓	
	30 Series	4-Wire System		✓	
	40 Series	6-Wire System			✓
	44 Series	6-Wire System			✓
	52	3-Wire System	✓		
	70	7-Wire System			✓
	78	7-Wire System			✓
	80	7-Wire System			✓
	88 Series	7-Wire System			✓
	100	4-Wire System		✓	
	150	4-Wire System		✓	
	MC170	4-Wire System		✓	
	200	4-Wire System		✓	
	220	4-Wire System		✓	
	250	4-Wire System		✓	
	300 - MC300	4-Wire System		✓	
	MC302	4-Wire System		✓	
	330	4-Wire System		✓	
	333	4-Wire System		✓	
	338	4-Wire System		✓	
	350 - MC350	4-Wire System		✓	
	MC350A	4-Wire System		✓	
	440 Series	6-Wire System			✓
	MC500	7-Wire System			✓
	MC602	4-Wire System		✓	
	MC702	6-Wire System			✓
	MC800	7-Wire System			✓
	MC902	7-Wire System			✓
NuTone	2011/2012	3-Wire System	✓		
	2015/2016	3-Wire System	✓		
	2031/2032	3-Wire System	✓		
	2053/2054	3-Wire System	✓		
	2055/2056	3-Wire System	✓		
	2063/2064	3-Wire System	✓		
	2067/2068	3-Wire System	✓		
	2071	5-Wire System	✓		
	2090/2091	3-Wire System	✓		
	2401/2402	8-Wire System			✓
	2540/2541	6-Wire System			✓
	2542	6-Wire System			✓
	2561/2562	8-Wire System			✓
	IM-203	3-Wire System	✓		
	IM-313	3-Wire System	✓		
	IM-406	6-Wire System			✓
	IM-3204	4-Wire System		✓	
	IM-3303	3-Wire System	✓		
	IM-4006	6-Wire System			✓
	IM-4406	6-Wire System			✓
	IMA-203D	3-Wire System	✓		
	IMA-303	3-Wire System	✓		
	IMA-2003	3-Wire System	✓		
	IMA-3003	3-Wire System	✓		
	IMA-3303	3-Wire System	✓		
	M-3103	3-Wire System	✓		
	SM428	8-Wire System			✓

NOTE: All retrofit installations with existing "loop" wiring (master to station, station to station) must be replaced with "home run" wiring (master to each station)

# 28 Rough-In Kits

## DMC1H

### Wall Housing Kit

• ORDER # DMC1H

The Model DMC1H Wall Housing Kit offers many of the components needed to rough-in a dmc1 or dmc3-4 intercom system. The kit includes the following:

- (1) - Metal wall housing for dmc1 or dmc3-4
- (1) - FM dipole antenna
- (1) - Ferrite filter
- (4) - 1.5-Inch snap-in bushings
- (1) - TE5D Transformer Assembly
- 75 feet of MS4DCXSC Shielded Speaker Cable
- 25 feet of antenna wire

#### Features:

- Rough-in components for professional installation
- Power transformer to power system master included



## DMC1HC

### CD Combination Wall Housing Kit

• ORDER # DMC1HC

The Model dmc1HC CD Combination Wall Housing Kit offers many of the components needed to rough-in a dmc1 or dmc3-4 intercom system with the optional dmc1CD Add-on 6-disc CD Changer. The kit includes the following:

- (1) - Metal wall housing for dmc1 or dmc3-4 with dmc1CD
- (1) - FM dipole antenna
- (1) - Ferrite filter
- (1) - TE2D Transformer Assembly
- (1) - TE5D Transformer Assembly
- 75 feet of MS4DCXSC Shielded Speaker Cable
- 25 feet of antenna wire

#### Features:

- Rough-in components for professional installation
- Power transformer to power system master included
- Power transformer to power CD changer included



**DMC1HKIT**

## Wall Housing and Rough-In Ring Kit

• ORDER # DMC1HKIT



The Model DMC1HKIT Wall Housing and Rough-in Ring Kit offers many of the components needed to rough-in a dmc1 or dmc3-4 intercom system. The kit also includes rough-in rings for a door speaker, one outdoor patio station, and four indoor room stations. The kit includes the following:

- (1) - Metal wall housing for dmc1 or dmc3-4
- (1) - ME3 Door Speaker Rough-in Enclosure
- (1) - DMC1HRW Flush-mount Rough-in Enclosure
- (4) - DMC1HR-5 Rough-in Rings
- (1) - FM dipole antenna
- (1) - Ferrite filter
- (4) - 1.5-Inch snap-in bushings
- (1) - TE5D Transformer Assembly
- 75 feet of MS4DCXSC Shielded Speaker Cable
- 25 feet of antenna wire

For system components, order the Model DMC1PACK Music/Communication System Package

**Features:**

- Rough-in components for professional installation
- Rough-in rings for one door speaker, one patio station, and four room stations
- Power transformer to power system master included

**DMC1HCKIT** CD Combination  
Wall Housing and Rough-In Ring Kit

• ORDER # DMC1HCKIT



The Model DMC1HCKIT CD Combination Wall Housing and Rough-in Ring Kit offers many of the components needed to rough-in a dmc1 or dmc3-4 intercom system with the optional dmc1CD Add-on 6-disc CD Changer. The kit also includes rough-in rings for a door speaker, one outdoor patio station, and four indoor room stations. The kit includes the following:

- (1) - Metal wall housing for dmc1 or dmc3-4 with dmc1CD
- (1) - ME3 Door Speaker Rough-in Enclosure
- (1) - DMC1HRW Flush-mount Rough-in Enclosure
- (4) - DMC1HR-5 Rough-in Rings
- (1) - FM dipole antenna
- (1) - Ferrite filter
- (1) - TE2D Transformer Assembly
- (1) - TE5D Transformer Assembly
- 75 feet of MS4DCXSC Shielded Speaker Cable
- 25 feet of antenna wire

For system components, order the Model DMC1CDPACK Music/Communication System Package

**Features:**

- Rough-in components for professional installation
- Rough-in rings for one door speaker, one patio station, and four room stations
- Power transformer to power system master included
- Power transformer to power CD changer included

# 30 Rough-In Components

## **DMC1HR-5** Room Station Rough-In Ring (5-pack)

• ORDER # DMC1HR-5



The Model dmc1HR-5 Room Station Rough-in Ring (5-pack) is used to rough-in indoor room stations used with a dmc1 Music/Communication System installation. This rough-in ring is compatible with dmc1R and all colors of dmc1RS Indoor Room Stations.

## **DMC1HRW** Flush-Mount Rough-In Enclosure

• ORDER # DMC1HRW



The Model dmc1HRW Flush-mount Rough-in Enclosure is used to rough-in outdoor patio stations used with a dmc1 Music/Communication System installation. This metal rough-in enclosure is compatible with the Model dmc1RW Patio Station.

## **DMC1HRWS** Surface-Mount Rough-In Enclosure

• ORDER # DMC1HRWS



The Model dmc1HRWS Surface-mount Rough-in Enclosure is used to rough-in outdoor patio stations used with a dmc1 Music/Communication System installation. This plastic rough-in enclosure is compatible with the Model dmc1RW Patio Station.

## **DS3BXB** Intercom Door Station Enclosure (Black)

• ORDER # DS3BXB (Black)



The Model DS3BXB Intercom Door Station Enclosure is a surface-mount plastic enclosure. The enclosure is compatible with Model BD3BN, BD3N, D3BN, and D3N Door Stations.

## **DS3BXW** Intercom Door Station Enclosure (White)

• ORDER # DS3BXW (White)



The Model DS3BXW Intercom Door Station Enclosure is a surface-mount plastic enclosure. The enclosure is compatible with Model DS3 and DS3B Door Stations.

## **ME3** Door Station Rough-In Enclosure

• ORDER # ME3



The Model ME3 Door Station Rough-in Enclosure is used to rough-in indoor door stations used with dmc1 Music/Communication System installations. This rough-in enclosure is compatible with all colors and models of door stations except Model DMC-10DS.

# Rough-In Components 31

## SMP8

### Surface-Mount Enclosure

- ORDER # SMP8



The Model SMP8 Surface-mount Enclosure is used in surface-mount applications to rough-in 8-inch speaker room stations used with dmc3-4 Music/Communications System 4-wire retrofit installations.

This white plastic rough-in enclosure is compatible with the Model N68RS and NW68RS Room and Patio Stations

## NR8-5 Ceiling Intercom Speaker Mounting Ring (5-pack)

- ORDER # NR8-5



The Model NR8-5 Ceiling Intercom Speaker Mounting Ring (5-pack) is a rough-in ring designed to fit 8-inch Model NR8P Ceiling Intercom Speaker.

## FMSMR-2

### Speaker Mounting Ring Pair

- ORDER # FMSMR-2



The Model FMSMR-2 Speaker Mounting Ring Pair are two metal mounting rings designed for the Model FMSM In-wall Intercom Speaker.

## AWPMRX

### Mono Audio Rough-In Kit

- ORDER # AWPMRX



The Model AWPMRX Mono Audio Rough-in Kit includes a dual-ended RCA interconnect cable and a single-gang J-box for recessed mounting of AWP and AWPA Audio Input Wall Plates.

# 32 Wall Plates & Intercom Speakers

## AWP

Audio Input Wall Plate (White)

- ORDER # AWP (White)

## AWPA

Audio Input Wall Plate (Almond)

- ORDER # AWP (Almond)



### Features:

- External audio input connection for dmc1 and dmc3-4 music/communication system master unit
- Mounts in a single-gang J-box
- White or almond faceplate color
- Two pairs of color-coded stereo RCA jacks

## MVC1

Monaural Volume Control (White)

- ORDER # MVC1 (White)

## MVC1A

Monaural Volume Control (Almond)

- ORDER # MVC1A (Almond)



### Features:

- Monaural volume control
- Standard white or almond wall plate
- Designed for 45-ohm intercom speakers
- Mounts in single-gang J-box

## FMC8

Ceiling Intercom Speaker

- ORDER # FMC8



### Features:

- 2-Way, 8-inch recessed ceiling mount speaker
- 45-Ohm impedance for intercom use
- White frame and white metal grille
- No mounting ring required

## NR8M

Ceiling Intercom Speaker

- ORDER # NR8M



### Features:

- 8-Inch recessed ceiling mount speaker
- 45-Ohm impedance for intercom use
- White frame and white metal grille
- No mounting ring required

## NR8P

Ceiling Intercom Speaker

- ORDER # NR8P



### Features:

- 8-Inch recessed ceiling mount speaker
- 45-Ohm impedance for intercom use
- White frame and white plastic grille
- Requires NR8 Mounting Ring



# Intercom Speakers 33

## FMSM

### In-Wall Intercom Speaker

- ORDER # FMSM



#### Features:

- Single intercom speaker
- 2-Way, 6.5-inch in-wall speaker
- 45-Ohm impedance for intercom use
- White frame and white metal grille
- Requires FMSMR-2 Speaker Mounting Ring

## NW8

### Outdoor Intercom Cube Speaker (White)

- ORDER # NW8 (White)

## NW8B

### Outdoor Intercom Cube Speaker (Black)

- ORDER # NW8B (Black)

#### Features:

- For intercom use
- White or black cube speaker
- 45-Ohm impedance
- Hanger brackets and hardware included



# 34 Intercom Accessories

## D360

### FM Antenna

- ORDER # D360



The Model D360 FM Antenna is an omnidirectional turnstile-design FM antenna for use with the Model dmc1 and dmc3-4 Music/Communications Systems. Typically the antenna is mounted inside the attic. The antenna connects to the system with the supplied 30-foot, 300-ohm twin-lead cable.

## MC3

### 3-Note Chime Module

- ORDER # MC3



The Model MC3 3-note Chime Module is a module that can be installed in the dmc1 or dmc3-4 Music/Communication System masters.

To announce a visitor, the intercom system's doorbell chime sounds when the bell button is pressed on a door station connected to the intercom. The module can be set to play one, two, or three notes for the intercom's doorbell chime sound, with a different chime for each door.

## MC8

### 8-Note Chime Module

- ORDER # MC8

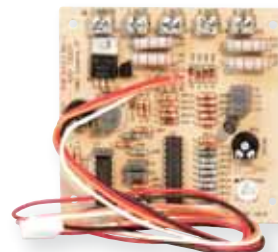

The Model MC8 8-note Chime Module is a module that can be installed in the dmc1 or dmc3-4 Music/Communication System Masters.

To announce a visitor, the intercom system's doorbell chime sounds when the bell button is pressed on a door station connected to the intercom. The module can be set to play one, two, four, or eight notes for the intercom's doorbell chime sound, with a different chime for each door.

## DMCRAC

### Antenna Adapter

- ORDER # DMCRAC

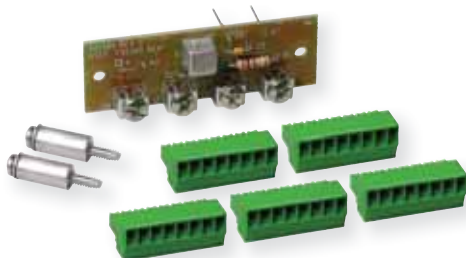

The Model dmcRAC Antenna Adapter is for dmc1 Music/Communication System master units that are used in 6-wire retrofit installations. The antenna adapter converts the dmc1 AM and FM antenna input connectors to screw terminals that can connect to the existing antenna wires in the installation.

The dmcRAC mounts onto the dmc1 radio tuner module and is only required for 6-wire retrofit dmc1 installations. For 3-wire and 4-wire retrofit installations, the dmc3-4 Music/Communication Retrofit System master is factory equipped with a dmcRAC already installed.

## DMC1QC

### Quick Connect Pack

- ORDER # DMC1QC



The Model dmc1QC Quick Connect Pack contains five replacement connectors for dmc1 Music/Communication System installations. These connectors connect the Cat-5 wire from room and patio stations to the dmc1 master.

The connectors are designed for use with Cat-5 cable. Each connector has press-down wire locks that cut through the wire's insulation, so no wire stripping is required.

## DMC1QCS

### Quick Connect Pack

- ORDER # DMC1QCS

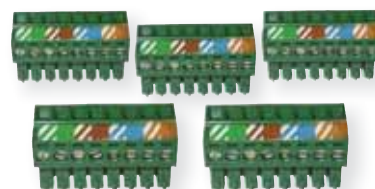

The Model dmc1QCS Quick Connect Pack contains five replacement connectors for dmc1 Music/Communication System installations. These connectors connect wires from room and patio stations to the dmc1 master.

The connectors are designed for use with all cable types. Each connector has screw-down terminals that secure the wires.

**DRW**

## Door Release Mechanism

- ORDER # DRW



The Model DRW Door Release Mechanism is an electro-mechanical device that will release a door strike when activated. The DRW can be used with dmc1, dmc3-4, and DMC-10 systems to grant access through a controlled door.

The door release mechanism is powered by a Model RT11 Power Transformer. The intercom system provides a relay contact closure to switch the power from the transformer to the door release.

**RT11**

## Remote Transformer

- ORDER # RT11



The Model RT11 Remote Transformer is a UL Listed, 24-volt AC with center tap, 40-VA plug-in wall transformer typically used as a local power supply for the Model DRW Door Release Mechanism.

The transformer is supplied with a 50-foot, 4-conductor cable.

**RT35**

## Remote Transformer

- ORDER # RT35



The Model RT35 Remote Transformer is a UL Listed, 24-volt AC with center tap, 40-VA direct wire transformer typically used as a local power supply for the Model DRW Door Release Mechanism.

**TE2D**

## Transformer Assembly

- ORDER # TE2D



The Model TE2D Transformer Assembly is an ETL Listed, 24-volt AC with center tap, 40-VA direct wire transformer used to power the Model dmc1CD Add-on 6-disc CD Changer. The transformer mounts in the bottom of a Model dmc1HC Wall Housing.

The transformer output wires are terminated with a connector that fits the dmc1CD changer.

**TE5D**

## Transformer Assembly

- ORDER # TE5D



The Model TE5D Transformer Assembly is an ETL Listed, dual-output 16-volt AC, 37-VA direct wire transformer used for power the Model dmc1 and dmc3-4 Music/Communications Systems. The transformer mounts in the bottom of Model dmc1H or dmc1HC Wall Housings.

The transformer output wires are terminated with a connector that fits the dmc1 or dmc3-4 master.

# 36 Music Distribution Systems

## XDM4600KIT

### Music Distribution System Kit

• ORDER # XDM4600KIT



#### Features:

- Four XDM46K Keypads and one DS3BS Door Speaker included
- XDM46CC Central Controller and XDM46R Remote Control included
- 20 Hz to 20 kHz frequency response
- 0.2% maximum total harmonic distortion
- 95 db minimum signal-to-noise ratio
- Central controller powered from 120 VAC
- Class D digital amplifier in each speaker zone keypad with 60 watts output power
- IR receiver built into each keypad; IR repeater in controller
- Four speaker zones expandable to eight speaker zones
- Keypad intercom privacy feature
- Keypads mount in standard double-gang J-boxes

## XDM46EH Music Distribution System Expansion Hub

• ORDER # XDM46EH



#### Features:

- Expands XDM system to up to eight speaker zones
- 20 Hz to 20 kHz frequency response
- 0.2% maximum total harmonic distortion
- 95 db minimum signal-to-noise ratio
- Expansion hub powered from 120 VAC
- Class D digital amplifier in each speaker zone keypad with 60 watts output power
- IR receiver built into each keypad; IR repeater in controller
- Keypad intercom privacy feature

# Music Distribution Systems 37

## XDM46K

### Music Distribution System Keypad

- ORDER # XDM46K



#### Features:

- 20 Hz to 20 kHz frequency response
- 0.2% maximum total harmonic distortion
- 95 db minimum signal-to-noise ratio
- Class D digital amplifier in each speaker zone keypad with 60 watts output power
- IR receiver built into each keypad; IR repeater in controller
- Keypad intercom privacy feature
- Keypad mounts in double-gang J-box

## XDM46R Music Distribution System Remote Control

- ORDER # XDM46R



#### Features:

- Infrared remote control for XDM system
- Remote can learn codes from other remotes
- Large LCD display
- Source component display names can be customized
- Programmable macros with up to 20 steps each
- Powered by four AAA batteries
- Low-battery indicator

## XDMWP Music Distribution System Audio Input Wall Plate

- ORDER # XDMWP



#### Features:

- Local audio input wall plate for XDM46K Keypad
- White wall plate faceplate
- Connects local line-level stereo or monaural audio source
- Line-level stereo audio output jacks for subwoofer or loop-through
- Wall plate mounts in single-gang J-box

## DS3B2

### XDM System Intercom Door Station With Bell Button

- ORDER # DS3B2



#### Features:

- White faceplate
- Lighted doorbell button
- 2-Way voice communications
- Mounts in Model ME3 Door Station Rough-in Enclosure

# 38 Music Distribution Systems

## **XDM46KAF** Music Distribution System Keypad Color Kit (4-pack) (Almond)

• ORDER # XDM46KAF

## **XDM46KBF** Music Distribution System Keypad Color Kit (4-pack) (Black)

• ORDER # XDM46KBF

### Features:

- Almond-colored or black faceplates and wall plates
- Changes keypad color or replaces damaged or worn keypad components
- Fits XDM46K Keypads
- Four sets included in each kit



## **XDMCKIT** Music Distribution System Replacement Connector Kit

• ORDER # XDMCKIT

## **XDMIRE** Music Distribution System Replacement Emitter Kit

• ORDER # XDMIRE



### Features:

- Plug-in screw terminal connectors for XDM46CC and XDM46EH
- Eight 4-position speaker zone keypad data connectors
- Two 8-position speaker zone keypad power connectors
- One 8-position door speaker data/power connector

### Features:

- Six infrared emitters for controlling source components
- Emitters for replacement or re-work purposes
- Adhesive backing on emitters for placing over source component IR receiver window
- 10-Foot cable and mini-plug on each emitter



# Training Outline & Types

Technical Services is the group within Linear LLC that administers Continuing Education Unit (CEU) activities, courses, and programs. Technical training ensures the education and meets the goals of the dealers, distributors, and others who sell the Linear LLC branded products.

The technical training manager reviews the policies and procedures and ensures they meet accreditation requirements for CEUs. Linear LLC accredits their training through the National Burglar & Fire Alarm Association (NBFAA) service of the National Training School. The review process for every program occurs every two years at a minimum.

Linear will ensure the training provides adequate resources to support a positive learning environment. Instructors will be available to provide assistance and support to students.

When students meet the requirements for satisfactory completion of the training program, they are issued a certificate that indicates the title of the program, the name of the instructor, and the number of CEUs for the program. Training in Texas will result in an additional form with the instructors' numbers annotated for state requirements.

Linear maintains the records for approximately one year and can reissue certificates if desired. Information collected during training is only for the use of documenting students attending class and is not sold, released, or transferred for any other purposes.

Linear training is provided by qualified personnel with many years of experience in the field and competence in their topic of instruction. They also have knowledge and skill in instructional methods and learning processes. Feedback is encouraged and collected. Instruction is provided with no discrimination, and the trainers are not compensated for any activity other than for classroom instruction.

## Linear offers three types of training through [learnlinear.com](http://learnlinear.com)

**Type 1: Instructor Lead Training—On-Site Training**  
We have product trainers and a sales management team who travel the U.S. to provide training at your facility or at a local distributor. This is a more traditional, classroom-style training option.

Linear programs are divided into four phases of courses. Many of Phase 3 and Phase 4 classes are NTS-approved for installers needing Continuing Education Units (CEUs).



**Phase 1:** Marketing and Investment Strategies—This presents how our products fit into the market segment. It will outline market share and profitability while showing projected future growth and outlook of product segments. It will show how to leverage your investment into our broad product offerings and maximize profitability.

**Phase 2:** Sales Training—This covers creating the right expectations for your customers. It goes over qualification questions to ask in order to qualify design to meet customer expectations. It also explains features and advantages by product, enabling you to differentiate products in a way your customer will understand.

**Phase 3:** Design and Installation Training—This is a brief product overview and explanation of installation and rough-in guidelines. The owner's manuals are reviewed (more than just packing material!). Configuration and system testing is illustrated. Instruction is given to show the customer how to use their new products in their home.

**Phase 4:** Troubleshooting and Advanced Theory—Very specific installation techniques are explained. Navigating troubleshooting guides and EMI and RFI influences are explored. Chronic problem installations and their root causes, as well as steps required that help avoid future call outs, are illustrated.

**Type 2: Instructor Lead Training—Computer-Based Training**  
A product trainer remotely teaches a course using teleconferences and computer software to present the material. Since a live instructor is leading the training, these classes are scheduled.

Linear offers the ability to take most of the on-site training presentations over the Internet, with an instructor leading the training.

**Type 3: Self-Paced Training—Computer-Based**  
This is similar to taking online college classes. From the convenience of either home or office, you can take classes at your own pace and return to previous sessions should you need to stop mid-class.

If you have any questions, feel free to email at [techsupport@linearcorp.com](mailto:techsupport@linearcorp.com) or call **1-800-421-1587** and ask for our training manager.



## 40 Technical Support

### Linear's Technical Services Support



Linear's Technical Services Department provides telephone support for our expanding product line. The group supports nearly 1,000 products in various types of installations and applications. Application engineers can assist dealers and installers with their technical questions regarding every Linear product.

The application engineers answer questions regarding equipment installation, programming, system design, troubleshooting, and inter-system compatibility. Questions could be about radio controls, security systems, access controls, door operators, gate operators, audio or video equipment, and accessories. Often, installers simply need fast help with their installation issues so they can complete the job and continue on to the next installation. Linear's quality and professional technical support staff provides that service.

The new extended Technical Services Department telephone service hours (5:00 AM to 4:30 PM Pacific Time) will be of value to nationwide installers and company representatives alike. West Coast callers will be able to call as early as 5:00 AM local time, and East Coast callers will be able to call as late as 7:30 PM local time.

Linear Technical Services provides direct access to the people who know Linear products best. To speak with a Linear expert, call 1-800-421-1587 and press 3.

## State-of-the-Art Manufacturing Facility

Sound plans implemented with quality products and solutions to support them are critical to success in today's competitive global business environment. With a state-of-the-art manufacturing facility in China, Linear uses industry-leading manufacturing technologies that enable production of quality products that consistently raise the standard in home technology and provide a value you can depend on in today's competitive marketplace.



High-performance production tools, advanced technologies and techniques in design and testing, integrated circuitry, microchip, and surface mount technology, as well as the latest electronic component assembly and quality assurance techniques are features you can depend on from Linear manufacturing. Linear's Hong Kong manufacturing operation boasts a staff of more than 1,300 and is ISO 9001:2000 quality system certified.

## West & East Distribution Centers



To streamline order fulfillment and shorten delivery time for Linear distributors and dealers, Linear LLC maintains two fully stocked regional distribution facilities in Vista, California, and Summerville, South Carolina.



Linear's Western Distribution Center has 90,000 square feet with 19 shipping docks. Linear's Eastern Distribution Center boasts 175,000 square feet with 25 shipping docks and is the third largest UPS shipper in the Charleston, South Carolina, area.

Both warehouse locations are completely equipped with shipping, receiving, and quality control facilities, and they each stock tens of thousands of Linear products for security, entry systems, communications, audio/video/data, central vacuum systems, and personal emergency response. Each warehouse team receives dozens of cargo containers each month, processes hundreds of orders daily, and ships thousands of packages with Linear goods to worldwide destinations each day.

# 42 Index

PRODUCT	ORDER #	PAGE
AWP	AWP (White)	32
AWPA	AWPA (Almond)	32
AWPMRX	AWPMRX	31
BD3BN	BD3BN	9, 16, 23
BD3N	BD3N	9, 16, 23
D360	D360	34
D3BN	D3BN	9, 16, 23
D3N	D3N	9, 16, 23
DMC1	DMC1 (White)	7
DMC-10AWP	DMC-10AWP	4
DMC-10DFAB-4	DMC-10DFAB-4	5
DMC-10DFBB-4	DMC-10DFBB-4	5
DMC-10DFSN-4	DMC-10DFSN-4	5
DMC-10DFW-4	DMC-10DFW-4	5
DMC-10DS	DMC-10DS	4
DMC-10H	DMC-10H	4
DMC-10KIT	DMC-10KIT	3
DMC-10PFAB-4	DMC-10PFAB-4	5
DMC-10PFBB-4	DMC-10PFBB-4	5
DMC-10PFSN-4	DMC-10PFSN-4	5
DMC-10PFW-4	DMC-10PFW-4	5
DMC-10PS	DMC-10PS	4
DMC-10RFA-4	DMC-10RFA-4	5
DMC-10RFB-4	DMC-10RFB-4	5
DMC-10RFW-4	DMC-10RFW-4	5
DMC-10RS	DMC-10RS	4
DMC1A	DMC1A (Almond)	7
DMC1B	DMC1B (Black)	7
DMC1CD	DMC1CD (White)	7, 14, 20
DMC1CDA	DMC1CDA (Almond)	7, 14, 20
DMC1CDB	DMC1CDB (Black)	7, 14, 20
DMC1CDPACK	DMC1CDPACK	6
DMC1F	DMC1F (White)	10
DMC1FA	DMC1FA (Almond)	10
DMC1FB	DMC1FB (Black)	10
DMC1FG	DMC1FG	10
DMC1FRG	DMC1FRG	10
DMC1H	DMC1H	28
DMC1HC	DMC1HC	28
DMC1HCKIT	DMC1HCKIT	29
DMC1HKIT	DMC1HKIT	29
DMC1HR-5	DMC1HR-5	30
DMC1HRW	DMC1HRW	30
DMC1HRWS	DMC1HRWS	30
DMC1PACK	DMC1PACK	6
DMC1QC	DMC1QC	34
DMC1QCS	DMC1QCS	34
DMC1R	DMC1R	8
DMC1RS	DMC1RS (White)	8
DMC1RSA	DMC1RSA (Almond)	8
DMC1RSB	DMC1RSB (Black)	8
DMC1RW	DMC1RW	8
DMC3-4	DMC3-4 (White)	14, 20
DMC3-4A	DMC3-4A (Almond)	14, 20
DMC3-4B	DMC3-4B (Black)	14, 20
DMC3R	DMC3R	15
DMC3RS	DMC3RS (White)	15
DMC3RSA	DMC3RSA (Almond)	15
DMC3RSB	DMC3RSB (Black)	15
DMC3RW	DMC3RW	15
DMC4R	DMC4R	21
DMC4RS	DMC4RS (White)	21
DMC4RSA	DMC4RSA (Almond)	21
DMC4RSB	DMC4RSB (Black)	21
DMC4RW	DMC4RW	21
DMCFC	DMCFC (White)	17, 24
DMCFCA	DMCFCA (Almond)	17, 24
DMCFCB	DMCFCB (Black)	17, 24
DMCFD	DMCFD	18, 25
DMCFM	DMCFM (White)	17, 24
DMCFMA	DMCFMA (Almond)	17, 24
DMCFMB	DMCFMB (Black)	17, 24
DMCFR	DMCFR (White)	18, 25
DMCFRA	DMCFRA (Almond)	18, 25
DMCFRB	DMCFRB (Black)	18, 25
DMCFRW	DMCFRW	18, 25
DMCRAC	DMCRAC	34
DRW	DRW	35

PRODUCT	ORDER #	PAGE
DS3	DS3	9, 16, 23
DS3B	DS3B	9, 16, 23
DS3B2	DS3B2	37
DS3BXB	DS3BXB	30
DS3BXW	DS3BXW	30
DS3NB	DS3NB	9, 16, 23
FMC8	FMC8	32
FMSM	FMSM	33
FMSMR-2	FMSMR-2	31
MC3	MC3	34
MC8	MC8	34
ME3	ME3	30
MS2SX5SC	MS2SX5SC	11
MS4DCX5SC	MS4DCX5SC	11
MVC1	MVC1 (White)	32
MVC1A	MVC1A (Almond)	32
N68RS	N68RS	22
NR8-5	NR8-5	31
NR8M	NR8M	32
NR8P	NR8P	32
NW65RS	NW65RS	22
NW68RS	NW68RS	22
NW8	NW8 (White)	33
NW8B	NW8B (Black)	33
PBVM127X1	PBVM127X1	11
RT11	RT11	35
RT35	RT35	35
SMP8	SMP8	31
TE2D	TE2D	35
TE5D	TE5D	35
XDM4600KIT	XDM4600KIT	36
XDM46EH	XDM46EH	36
XDM46K	XDM46K	37
XDM46KAF	XDM46KAF	38
XDM46KBF	XDM46KBF	38
XDM46R	XDM46R	37
XDMCKIT	XDMCKIT	38
XDMIRE	XDMIRE	38
XDMWP	XDMWP	37



# Linear

---

## Communications Solutions

Linear LLC 1950 Camino Vida Roble, Ste. 150, Carlsbad, CA 92008 USA  
**1 800 421 1587 / [linearcorp.com](http://linearcorp.com)**

***Linear***<sup>®</sup>  
*Building On Innovation.*

Copyright 2008, Linear LLC    P/N 228651A    Printed in China